

Još jedanput ono najvažnije:

- Prilikom loženja dodajte samo onu količinu goriva koja odgovara potrebnoj toplinskoj snazi u tom trenutku.
- Nakon dodavanja goriva regulator zraka dovoljno otvorite dok se vatra dobro ne razgori. Tek tada možete staviti regulator u položaj koji odgovara željenoj toplinskoj snazi.
- U potpunosti se pridržavajte tehničkih uputa.
- Peć postavite u prostoriju odgovarajuće veličine tako da potreba topline odgovara nazivnoj snazi peći.
- Preko noći potpuno zatvorite regulator da ujutro imate dovoljnu osnovnu žar, te da bez problema možete uspostaviti novu vatru. Za to morate imati ponovno suha i sitna drva.
- Kod čišćenja, tj. odstranjivanja pepela ostavite dovoljno pepela, da kompletna donja ploča, bude prekrivena u visini valovitih rebara. Tako omogućavate dugotrajno zadržavanje žari, te štite donju ploču.

Rezervni dijelovi - pribor: (Slika 6., stranica 44)

Poz. br.	Naziv dijela	Oznaka odljevka
103	PREDNJICA	VE-103
110	KOŠ	VE-110
111	POKLOPAC KOŠA	VE-111
112	STRANICALOŽIŠTA DONJA	VE-112
116	DIMNI NASTAVAK	TE-119
117	POKLOPAC KUPOLE	VE-117
120	ŠTITNIK STAKLA	VE-120
121	POSTOLJE	VE-121
122	KUPOLA	VE-122
123	VRATA	VE-123
124	REGULATOR	VE-124
125	OKVIR LADICE	VE-125
126	MASKALADICE	VE-126
127	MASKANIŠE	VE-127
128 A	ZAŠTITA PLAŠTA	VE-128
129	POKLOPAC ZAŠTITE	VE-129
133	STRANICALOŽIŠTA ZAČELJE	VE-133
200	DRŽAČ STAKLA	
202	DNO	
205	PEPELJARA	
212	LIM POSTOLJA	
217	LIM SEKUNDARNOG ZRAKA	
218	VODILICA PEPELJARE	
224	NOSAČ BOČNICE	
225	ŠTITNIK ZAČELJA	
226	BOČNICA	
227	LIM REGULATORA	
228	PLAŠT	
232	USPORIVAČ	
233	GORNJAPLOČA	
234	PLOČA	
301	STAKLO	
0-11	NIŠA	
01-000	RUČKA VRATALOŽIŠTA	
04-000	ŠARKA I DRŽAČ ŠARKE	
10-000	OPRUGA VRATA-sklop	
	PRIBOR:	
801	ŽARAČ	
802	GREBILICA	
806	ZAŠTITNA RUKAVICALOGO PLAMEN-crvena	

ZADRŽAVAMO PRAVO NA PROMJENE KOJE NE UTJEČU NA FUNKCIONALNOST I SIGURNOST APARATA.

Remember:

- When reloading, make sure to load a quantity of fuel that is most suitable in respect of the actual heating requirements.
- After reloading, open the air supply control as required until bright fire is developed. Only then, set the air supply control to the position corresponding to the desired heating output.
- Strictly observe these Installation and Operating Instructions.
- Install the stove in a room of adequate size to ensure that the rated output of the stove meets the heating requirements of the room.
- Over the night, keep the air supply control closed to maintain the ember bed until the next morning to set the new fire easily with dry kindling.
- When cleaning, i.e. removing the ash, make sure that sufficient ash is left to cover the entire lower plate at the undulated ribs level and thus to ensure long-lasting ember and to protect the lower plate.

Spare parts & accessories (Figure 6, Page 44)

ITEM NO.	DESCRIPTION	PART NO.
103	FRONT FRAME	VE-103
110	FIREBOX PAN	VE-110
111	FIREBOX PAN COVER	VE-111
112	FIREBOX WALL LOWER	VE-112
116	FLUE CONNECTION	TE-119
117	DOME LID	VE-117
120	GLASS SHIELD	VE-120
121	BASEPLATE	VE-121
122	DOME	VE-122
123	DOOR	VE-123
124	AIR SUPPLY CONTROL	VE-124
125	DRAWER FRAME	VE-125
126	DRAWER FRONT PANEL	VE-126
127	NICHE FRAME	VE-127
128 A	SHELL GUARD	VE-128
129	GUARD COVER	VE-129
133	FIREBOX WALL REAR	VE-133
200	GLASS HOLDER	
202	BOTTOM	
205	ASH TRAY	
212	BASEPLATE SHEET	
217	SECONDARY AIR CONTROL PLATE	
218	ASH TRAY GUIDE	
224	SIDE PANEL SUPPORT	
225	REAR GUARD	
226	SIDE PANEL	
227	AIR SUPPLY CONTROL SHEET PLATE	
228	SHELL	
232	SLOWER PLATE	
233	TOP PLATE	
234	PLATE	
301	GLASS	
0-11	NICHE	
01-000	FIREBOX DOOR HANDLE	
04-000	HINGE AND HINGE HOLDER	
10-000	DOOR SPRING – SET	
	ACCESSORIES:	
801	GRIP	
802	SCRAPER SET	
806	PROTECTIVE GLOVE LOGO PLAMEN - red	

WE RESERVE THE RIGHT TO MAKE MODIFICATIONS NOT AFFECTING THE FUNCTIONALITY AND SAFETY OF THE STOVE!

Rezervni dijelovi - pribor; Ersatzteile - Zubehör; Spare parts & accessories;
 Rezervní díly – příbor; Rezervni deli - pribor; Резервни делови - прибор:

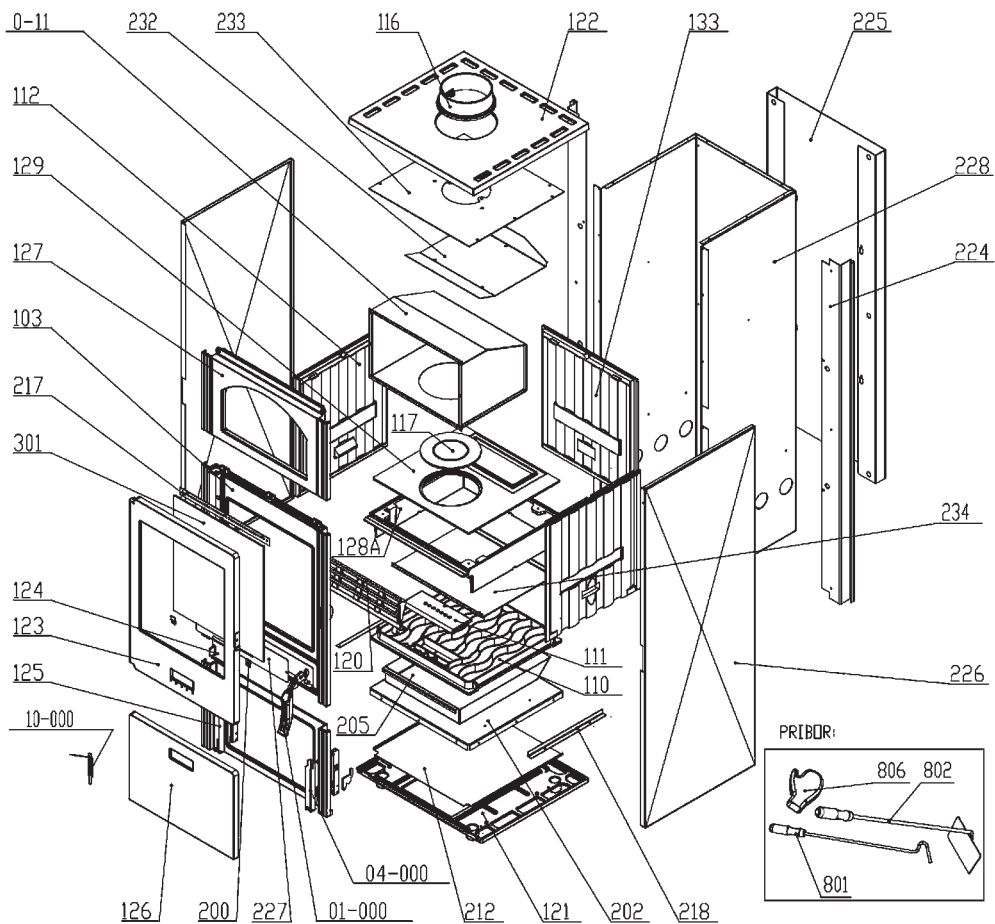

08.2015.

Slika 6; Bild 6; Figure 6; Obrázek 6; Слика 6